

FREE TO CHOOSE INNOVATIONS



HRTM 8761 CI+

X X X
X X X
X X X
X X X
X X X
X X X
X X X
X X X
X X X
X X X
X X X
X X X
X X X
X X X
X X X
X X X
X X X
X X X
X X X
X X X



User manual (EN)



Content

Safety Precaution	3
Reference	4
General Features	4
Accessories	4
Product Overview	5
Front Panel	6
Rear Panel	7
Remote Control Unit (RCU)	8
Installation.....	10
Powering On	10
Initial setting	10
Auto Search	10
Edit Channel	11
TV Channel List	11
System Setup	11
Language	11
TV System	11
Display Setting	11
Local Time Setting	11
Timer Setting.....	12
Parental Lock	12
Tools	12
Information	12
Factory Setting	12
Common Interface	12
USB Upgrade & Save	12



Media Player	13
REC Setting	17
PVR Storage Setting	17
PVR Setting	17
Basic Operation	17
Audio	17
EPG	17
Subtitle	17
TXT	17
Channel List	18
OK List	18
Favorite List	18
USB Control	18
Recording and Timeshift	18
Recording List	18
Additional Information	20
Trouble Shooting	20
Limited Warranty	21

Safety Precaution

This STB has been designed and manufactured to satisfy the international safety standards. Please read the following safety precautions carefully before operating this receiver.

Main Supply:

Before operating, please check the units operating voltage is 230V AC 50/60Hz.

Overload:

Do not overload a wall outlet, extension cord or adapter, neither use damaged power cord or touch it with wet hand as this may result in electric shock.

Liquid:

The receiver shall not be exposed to dripping or splashing water, and that no objects filled with liquids, such as base, shall be placed on the apparatus.

Ventilation:

Keep the slots on top of the receiver uncover to allow sufficient airflow to the unit. Do not put the receiver on soft furnishings or carpets. Do not expose the receiver to direct light or do not place it near a heater or in humid conditions. Do not stack other electronic equipments on top of the receiver.

Cleaning:

Plug out the receiver from the wall outlet before cleaning. Clean the receiver by a soft cloth or mild solution of washing-up liquid (no solvents).

Connection:

Disconnect the receiver from the mains when you connect or disconnect it to Cable.

Location:

Put the receiver indoor in order to avoid lightening, raining or sunlight.

Uncover:

Do not remove the cover, to reduce the risk of electric shock. Contact qualified and licensed service personnel to repair the receiver, or contact your dealer.



Reference

General Features

- DVB-T2/C Compliant (MPEG-II/ MPEG-IV/ H.264)
- Sensitive Tuner with Loop-Through
- Auto Search supported
- PAL/NTSC Conversion
- True full Color (16 bits) on screen display (OSD)
- Storing memory: 5000 channels
- Favorite group and parental lock supported
- CI/CI+ supported
- Multi-language menu supported
- Multi-language audio supported
- Multi-language DVB Subtitle output
- Electronic Program Guide (EPG)
- Teletext
- USB 2.0 Interface

Accessories

- Users manual
- Remote Control Unit with Batteries





Product overview

Front panel

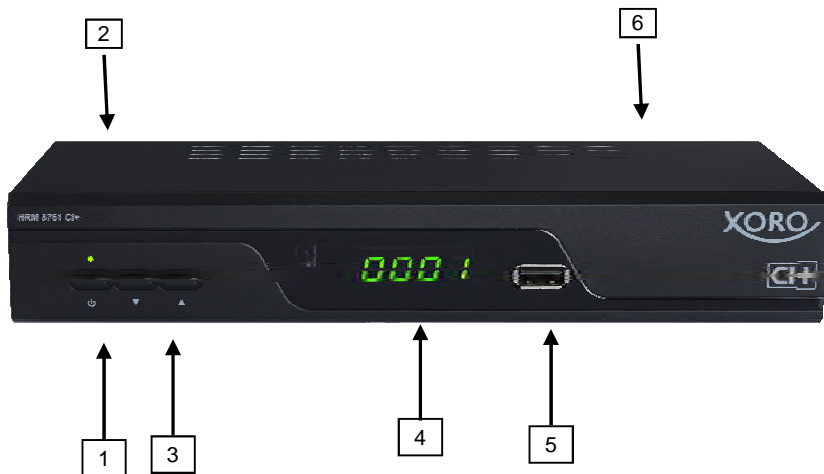

- 1. Power button** Switch between operation and standby modes.
- 2. Power LED** Power indicator
- 3. ▲ / ▼** Change channel in viewing mode and move the cursor up/down in menu mode.
- 4. Display** It displays channel information. In standby mode it displays local time.
- 5. USB** USB2.0 port (USB 1)
- 6. CI+ slot** CI / CI + shaft (behind the flap)



Connectors



Rear panel

English

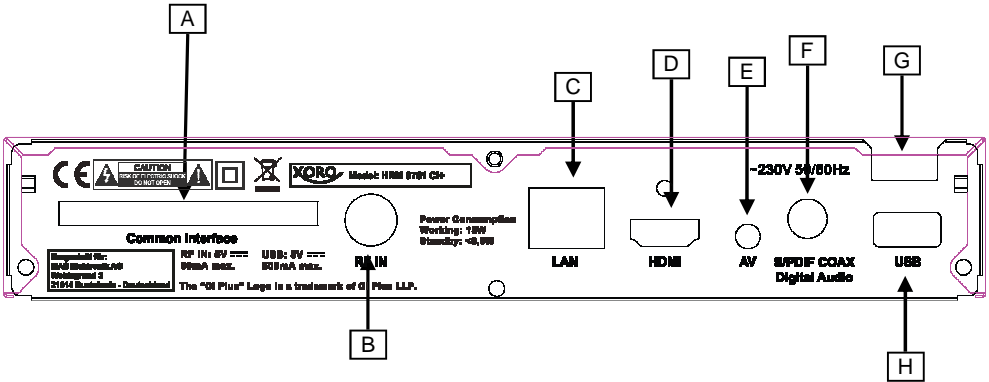

- A CI/CI+ slot
- B Cable in / Antenna in
- C LAN
- D HDMI in
- E AV out
- F S/PDIF (Digital Audio Coaxial)
- G Power cable
- H USB 2.0 (USB 2)

Note:

Disconnect all devices from the power supply before making or disconnecting cable connections to other devices.



Remote Control

Insert the battery and operating radius



- Insert the batteries into the compartment. Please ensure correct polarity (+/-) when inserting the battery.
- Slide the battery door open again.
- Always point the remote control at the remote sensor (remote control receiver). The distance to the device should not be more than 5 meters and the operating angle should not be greater than 60 °.
- Remove the batteries from the remote control when you are not using the receiver for an extended period of time.

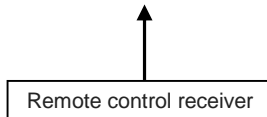

Note:

- Remove and renew old batteries. Old batteries can leak and damage the remote control.
- Remove the battery with a cloth. Avoid skin contact with the liquid.
- If swallowed, seek medical advice immediately (show the label where possible).
- In case of skin or eye contact, wash the skin / eyes and consult a doctor.



Remote Control Unit (RCU)



1. Power button
2. Mute button
3. **USB**: Browse PVR data in USB device
4. **TIMER**:
5. **SUB-T**: Display the subtitle language list
6. **AUDIO**: Display the audio list
7. **◀◀**: Fast rewind.
8. **▶▶**: Fast forward.
9. **◀◀◀**: Previous.
10. **▶▶▶**: Next.
11. **▶**: Play.
12. **||**: Pause/Step
13. **■**: Stop
14. **●**: Record
- 15-18. **RED / GREEN / YELLOW / BLUE BUTTON**
19. **MENU**: Activate main menu
20. **EXIT**: Exit current menu step by step
21. **◀ / ▶**: Change volume in viewing mode.
22. **▲ / ▼**: Changes program
23. **OK/LIST**: Confirm / Channel list
24. **i**: Display the program information
25. **↶**: Switch to the previous viewed channel
26. **VOL+/VOL-**: Change the volume
27. **EPG** (Electronic Program Guide): Display the program guide
28. **TXT**: Display the teletext.
29. **PAGE▲/▼**: Page up/down
30. **NUMERIC KEY** (0~9): Enter a TV/radio channel number or menu option number
31. **TV/R**: Switch between TV and RADIO in Channel list
32. **FAV**: Display favorite channel list

Note:

The function of some buttons is only available if the corresponding operating mode has been activated before. Function is only available when the media player is activated and two USB devices are connected. Please refer to the further descriptions in the manual and the instructions on the screen.

Installation

You should install the receiver when powering on your product for the first time after purchase.

Tip: The default password is **0000**. If you have forgotten your password, please contact your local product distributor.

Powering On

1. Connect the power cord of the product to a wall outlet.
2. Power on by pressing the **POWER** button on the remote control or the **POWER** button at the front of the product.

Initial setting

When you first use, you need to select the OSD language, Tuning Type, Country Region,

You can see some options in this menu. There are Frequency, Symbol Rate, Scan QAM Type, and Search.

➤ **Frequency**

You can input the correct frequency with numeric button (0-9).

➤ **Symbol Rate**

You can input the correct symbol rate with numeric button (0-9).

➤ **Scan QAM**

You can press the ◀ / ▶ button to select the scan QAM. There are 16-QAM, 32-QAM, 64-QAM, 128-QAM and 256-QAM options.

➤ **Search** Press **OK** button to start search.

*. Easily switch DVB-C / DVB-T2. **Menu->Channel->DVB Tuning Type**, with the ◀ / ▶ buttons.

Auto Search

Auto Search allows you to configure the cable setting parameters. **Menu->Channel->Auto Tuning**

Before search, you can select the country, and then you must select the correct network option which you want to search. And then move highlight to **Search**, and press **OK** button to search.



Program Edit

TV Channel List

Edit Channels enables you to move, delete, skip the channels in the channel list conveniently, and set favorite.

Tip: Radio Channels operation similar to the TV Channels.

System Setup

OSD Language

Enter **OPTION** menu, you can set the OSD Language, Audio Language, Subtitle Language.

TV System

Enter **PICTURE** menu, you can set the TV System, Video Resolution, and Aspect Mode.

Local Time Setting

Enter **TIME** menu, the Local Time Setting contains option for GMT Offset & Summer Time.

Timer Setting

Menu->System Setup->Timer Setting

You can setup a *View* or *Record* Timer here. Select a timer and press OK button.

Timer Mode

Once: only one time.

Daily: Repeat every day.

Off: Close this timer.

Weekly: Repeat the channel weekly.

Mo-Fr: Repeat the channel from Monday to Friday.

Sa-Su: Repeat the channel from Saturday to Sunday.

Timer Service

Channel: Will switch to the channel when the timer is started.

Record: Only if there is a USB device, it will be recorded automatically when the timer is started. And the recorded PVR will be saved in USB device.

Wakeup Channel Select the Channel from Channel List.

Event Name If you add a event timer from EPG, it shows the event name.

Wakeup Date Input start date of the timer.

On Time Set Start time of the timer.

End Time Set End time of the timer.

After Recording Set the status after the timer.

Auto: Back to the status that before the timer.

Standby mode: Go to standby mode after the timer.

Power on: Still power on after the timer.

Parental Lock

Parent Lock allows you to set limits for each program or change your previous password.

Other

1. Auto Standby It can standby automatic as the time that you set.

2. Standby Time You can set the time display on front panel when standby.

OPTION

Information

Display version information such as software or hardware.

Factory Setting

You have the opportunity to make undo all the settings and changes by load the default settings.

Note: All settings are reset. Then they should also perform the search again.

USB Upgrade & Save

Let you install a new software version on the device. This of course must be connected to a USB HDD or memory stick with the update file in the root directory.

Upgrade & Save

Visit www.xoro.de to get update Firmware.



Media Player

Media Player

Menu->APPLICATIONS->Media Player

It's Media Player. It can play many kinds of media files, you also can record channels and playback them and you can do various operations when using USB HDD or USB stick. You can press **VOL+VOL-** button to change media type in Image/Video/Record/Music.

Photo

If you want to display pictures with the HRM 8761 CI +, select the menu item Pictures with the ◀ / ▶ buttons. After successfully reading the USB memory, the directory structure is displayed in the file browser. Use the ▲ / ▼ buttons to select the desired folder and open it with the OK button. If there are pictures in this folder, these are listed and the first image is shown on the right as a thumbnail.

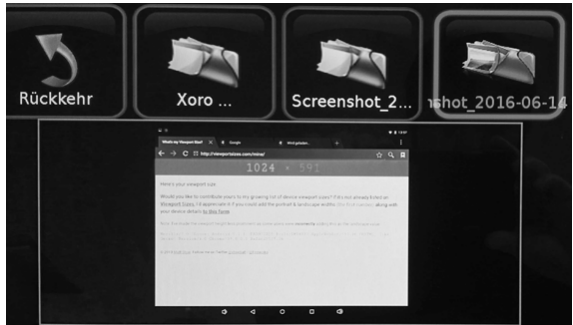

Available keys:

- OK: Start the slideshow of all images in this folder
- ▲ / ▼: Switches to the previous or next picture or folder
- TXT: Show thumbnails
- EXIT: Returns to the previous directory

Replay

Press the OK button to start playback. The following operations are available:

- ▲: Displays the next image
- ▼: Displays the previous image
- ◀: Rotation of the image by 90 ° counter-clockwise
- ▶: Rotation of the image by 90 ° clockwise
- PAUSE: Pause playback
- EXIT: Stop playback and return to the file browser

Music playback during image display

You can also listen to music during playback. To do this, you must first select the music piece and then switch to the pictures.

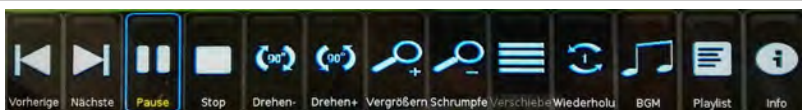

Playlist

Play: Show pictures

Stop: show pictures stop

Enlarge / Shrink

OK: Start the slideshow of all images in the list.

Supported formats

Image file (JPEG, BMP, PNG)

Music

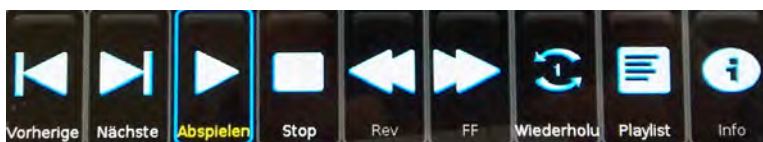

If you want to play music with the receiver, use the ◀ / ▶ buttons to enter the MUSIC menu item. After successfully reading the USB memory, the directory structure is displayed in the file browser.

Use the ▲ / ▼ buttons to select the desired folder and open it with the OK button.



Navigation aids in the file browser

- OK / PLAY: Plays the selected piece of music
- Playlist: Show playlist
- BACK: Sets the restore mode (single, folder, random folder)
- ▲ / ▼: Switches to the previous or next music file
- EXIT: Returns to the previous directory

Music playback

- >> |: Switch to the next piece of music
- | <<: Switch to the previous piece of music
- ||: PAUSE Interrupts the music playback
- <<: fast return
- >>: fast forward
- : Exits the music playback
- Back: Setting the repeat mode (single, folder, random folder)
- EXIT: Returns to the previous folder during playback

Playlist

- MENU: Show playlist
- OK: Starts playback of all files in the list

Supported formats

Music file (MP3, WAV, OGG)

Video

To view videos with the HRM 8761 CI +, press the ◀ / ▶ buttons to enter the VIDEO menu item. After successfully reading the USB memory, the directory structure is displayed in the file browser.

Use the ▲ / ▼ buttons to select the desired folder and open it with the OK button.

Supported formats

Due to the multitude of different video and audio formats, video cassettes and PC programs to create, it can happen that individual video files are not supported. Although each part of these files may be supported individually, a combination of these files can result in unplayable files.

The table provides an overview of supported containers, maximum resolution formats, and profiles.

Various codecs are supported. They must / should have been drawn up according to recognized standards. ISO / IEC 13818 applies to MPEG-2, ISO / IEC-14496 applies to MPEG-2.

Multiple audio tracks are supported in certain video containers

Suffix	Container	Video Codec	Max. Resolution	Bit rate
MPG	MPG	MPEG-1 / 2 MPEG-2	1920 x 1080 / 30p	20 Mbps
TS	MPEG-2 TS H264 TS	MPEG-1 / 2 /MP H.264 (Main, High Prof.)	1920 x 1080 / 30p	20 Mbps
MP4	MP4	MPEG-4 H.264 (Main, High Prof.)	1920 x 1080 / 30p	20 Mbps
MKV MOV	MKV MOV	MPEG1/ MPEG2/MP H.264 BP/MP/HP MPEG4 SP/ASP,Xvid	1920 x 1080 / 30p	20 Mbps
AVI	AVI	MPEG-1 / 2/MP/MPEG-4 SP/ASP H.264/Xvid	1920 x 1080 / 30p	20 Mbps

Notes: GMC is not supported.

Subject to errors and technical changes



PVR Storage Setting

Menu->OPTION->PVR File System->Select Disk

You can press **OK** button to see the selected partition information of USB HDD or memory stick. If you are connecting 2 USB device, then press **▲/▼** to change USB device.

PVR Setting

The PVR settings contain relevant options for the inclusion or time-shift function. These are Time Shift Size, Format Start, Speed Check, Always Timeshift (On/Off), Remaining Bytes of USB device, Remaining recording time.

OPTION

Audio

You can select the language you prefer in **Audio** if the current program is available in multiple audio languages.

EPG

You can view the EPG information of all channels in time and date order.

Here you can press the **▲/▼** button to change channel. Press the **◀/▶** button to change EPG event of the highlighted channel. Press the **OK** button to display the detail information of the highlighted EPG event. Press the **GREEN** button to enter **Timer Record** menu. After setup, press the **OK** button can add the highlighted EPG event to the Timer. Press the **I◀◀/▶▶I** button to browse EPG of day back or day forward.

Subtitle

You can select the language for the subtitle if the program provides subtitle information.

TXT

You can view the teletext information of this program.

This chapter will help you manipulate the channel list.

OK List

- 1) Press the **OK** button to enter the channel list while watching a program.
- 2) Press the **◀/▶** button to switch the Radio list / FAV group.
- 3) Press the **CH+/CH-** button to move the highlighting, and press OK button to watch the highlighting channel.

Favorite List

- 1) If you have set several favorite lists, press the **FAV** button can enter the favorite list.
- 2) Press the **▲/▼** button to change different favorite list and press the **OK** button can select a favorite group.
- 3) Press **▲/▼** button to select the channel in the current favorite list.

Note: If you selected a favorite list, press the **▲/▼** button can only change the channels in this favorite list and press the **OK** button can only display the channels in this favorite list.

USB Control

Start Recording

- 1) You can press the **●** button to start recording while watching a program.
- 2) If you have set the timer, and set the **Time Record** on, it will start recording automatically according to the start time of the timer.

Stop Recording

- 1) You can press the **■** button to stop recording. If you don't press the **■** button, it will stop recording according to the record duration.
- 2) If you have set the timer, it will stop recording automatically according to the stop time of the timer.
- 3) If the free space on the USB HDD or USB disk is insufficient, recording will stop.

Watch the Other Program while Recording

At the same time, If you record two channels from different TP, then you can only watch the program from the same TP that recorded. If you record one or two channels from the same TP, then you can watch all the programs.



Timeshift

Timeshifte allows you to pause a live broadcast and return to it later and continue where you left off.

In order to use the Time Shift function, you must navigate to Menu -> REC Setting -> PVR Setting-> Timeshift with the option "ON". And the timeshift will start automatically while play the program.

CAM Module

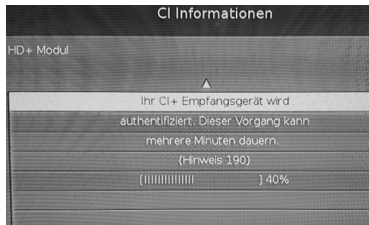

If you want to watch Pay-TV, then you need a CAM module with the appropriate subscription card. All the CAM modules which correspond with CI and CI+ standard are supported.

CI+ module authenticate

If you insert the CI+ module, it will appear the prompt box such as the right picture. Wait a few minutes, it will appear the other prompt box. The information is "Your Module is operational". Then the prompt box will disappear automatically.

Note: If you insert the module first time or switch to another module, the module will authenticate for a long time. Please wait patiently.

Trouble Shooting

Before contacting your local service centre, please read the tips below carefully. If the problem persists after completing the following procedure, please contact your local product distributor or service centre for further instructions.

1. No message displayed on the front display. (The product will not switch on.)

- Check the main power cable and make sure it is plugged into a suitable power outlet.
- Check that the mains supply is switched on.
- Connect the power cable to a different power outlet.
- Check that the power switch is on at the rear of the product.

2. No picture

- Make sure that the product is powered on and in operation mode. (Press the STANDBY button)
- Make sure that the AV/HDMI cable is firmly connected to the TV.
- Make sure that the antenna cable is properly connected to the product.
- Be sure to activate channel search.
- Check the brightness level of the TV.
- Check if the channel is currently on air. Contact the broadcaster to ensure that the channel is running.

3. Poor picture/sound quality

- Make sure there is no mobile phone or microwave oven near the product.

4. No or poor sound

- Check that your AV/HDMI cable is connected correctly.
- Check the volume levels of your TV set and the product.
- Check if the product or TV is on mute.
- Check audio type or soundtrack option. (where applicable)

5. Remote control does not operate.

- To control the product, the top end of the remote control should point directly towards the receiving part of the product.
- Remove and reinsert the batteries in the remote control.
- Replace the batteries in the remote control for a new set.



Limited Warranty

In case the products delivered are not free from defects in material or workmanship, MAS Elektronik AG has the right to either repair or replace the defective product at its choice. MAS Elektronik AG manufactures and repairs goods using components which are new or equivalent to new in accordance with industry standards and practice. The warranty for wearing parts (e.g. rechargeable batteries) is limited to 6 months.

In case the device is equipped with internal data storage (e.g. hard disc drive, Flash drive), the customer is responsible to backup his data before sending the device. MAS Elektronik AG is not liable for any data loss on returned devices. MAS Elektronik AG reserves the right to reset returned devices to factory defaults. Please note your personal settings for this reason.

MAS Elektronik AG is not liable for any accessories not belonging to original package content such as DVDs, hard disc drives, Flash storage devices, batteries, etc.

This limited warranty does not cover finishes, accessories or batteries, nor does it cover damage resulting from accident, misuse, abuse, dirt, water, battery leakage, tampering, servicing performed or attempted by unauthorized service agencies. This limited warranty does not cover damages resulting from firmware upgrades. Only in case of firmware upgrades needed to add functions promised at time of purchase, such damages are covered by this limited warranty. For a correct and frictionless completion of warranty or repairs you need a RMA No. You may obtain a RMA on the internet at www.mas.de/FAQ or by telephone.

Please send the device in its original packing material, all standard accessories and a copy of the invoice, a description of defect and the RMA No. to following address. Please note the RMA number clear and in large numbers on the outer package.

MAS Elektronik AG
Weidegrund 3
21614 Buxtehude
Germany

Support
e-mail: support@ersservice.de
Hotline: +49 (0)4161 800 24 24
Fax: +49 (0)4161 800 24 61
Internet: www.xoro.de/service



XORO by MAS Elektronik AG

**Weidegrund 3
21614 Buxtehude
Deutschland**

Tel: 04161 800 24 24

www.xoro.de

